

F.A.S.T CORPORATION WATER PLAY UNIT INSTALLATION

- ALL SUPER STRONG FIBERGLASS WALLS.
- LIGHTWEIGHT. NO ADDITIONAL FOUNDATION NECESSARY.
- WATER SPRAYS AT THE TOP OF SLIDE.
- SLIDE IS SUPPLIED WITH EASY 3/4 INCH PVC PLASTIC PIPE LOCATED WITH IN THE HOLLOW UNDERSIDE OF SIDE. (SEE B)
- WE WILL PAINT ANY COLOR OR COMBINATION OF COLORS. IF YOU ARE LOOKING FOR COLOR CHOICES, USE OUR COLOR CATALOGUE AS A GUIDE.
- SLIDES HAVE FLANGES AT THE BOTTOM FOR BOLTING TO THE DECK OR POOL FLOOR. (SEE C)
- STAINLESS STEEL HANDRAILS ARE SUPPLIED WITH GROUNDING WIRES. SIMPLY DRILL 1/2 INCH HOLES IN THE FLOOR, INSERT EXPANSION BOLT AND SECURE. (SEE D)

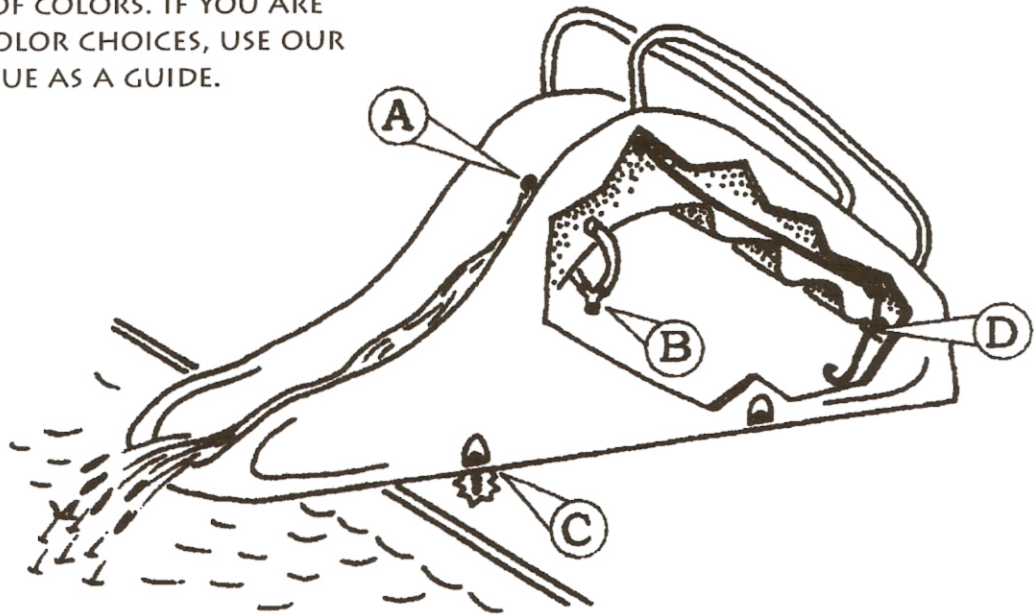

F.A.S.T CORPORATION WATER PLAY UNIT MAINTENANCE

- F.A.S.T SLIDES ARE DESIGNED FOR SIMPLE MAINTENANCE. AUTOMOTIVE CLEANER AND WAX SHOULD BE USED SEMIANNUALLY TO CLEAN AND PROTECT THE FINISH.
- PLUMBING IS COMMON PVC PIPES AND CONNECTIONS. IF THEY EVER DO WEAR OUT, PARTS CAN BE OBTAINED LOCALLY AND EASILY INSTALLED BY MAINTENANCE PERSONNEL.

FAST Landing Pads

Recommended for underwater application only.

FAST landing pads work best when completely immersed in water. They are **not recommended** for installation on splash pads or in water less than 2" deep.

1. Mark anchoring positions.
2. Drill ½" holes into pool or deck floor for SS anchors provided.
3. Set SS anchors using the 5/16" setting tool provided by tapping the wedge down until tight.
4. Set pad into position and tighten down using SS washers and screws provided. Tighten screws to 15 inch pounds. Ensure all anchors are installed and tight, but do not over tighten. Over torque screws may crack the backing board.
5. Insert enough silicone (provided) into each countersunk hole in the foam to cover the screw head (see illustration below).
6. Trim the narrow end (bottom) of the foam plugs provided so that they will sit flush in the countersunk holes atop the anchoring screw (see illustration below).
7. Insert trimmed foam plug into each countersunk hole. There should be enough silicone in each hole to hold the plug in place, while making it easy to remove for maintenance purposes.
8. If anchors loosen overtime, remove foam plugs and retighten each anchoring position. A loose landing pad will result in accelerated excessive wear around the anchoring positions. Once the anchors are retightened, repeat steps 5 through 7 above to reinstall the foam plugs.

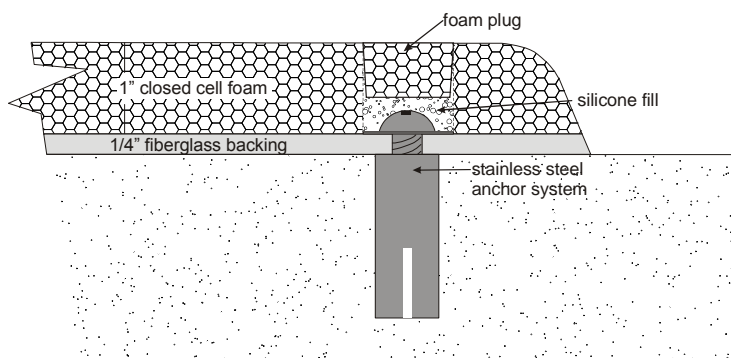

Stainless Steel Anchors included

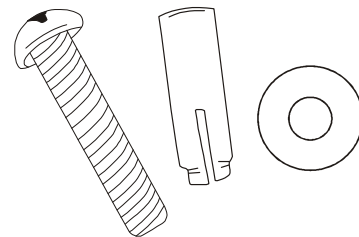

Features

- Stainless steel anchor system
- Fiberglass backing
- Gently rounded edges
- Non-slip surfaces
- Concentric bolt pattern
- Custom sizes available

Foam is made with BIOBLOK™, antimicrobial permanently bound in the product, eliminating fungus, mildew, mold, and bacteria growth.

